

IT'S CHRISTMAS TIME QUILT – Pattern #103

Block #6 - House

NOTE: Go to DKohn Designs on YouTube to find the detailed how-to videos.

UNFINISHED BLOCK SIZE: 9 ½" x 9 ½"

This block is a simple House block. This is Row #6 from the It's Christmas Time Row Quilt. Make **(5)** Blocks total for Row #6. *If you want a summary of the sashing, borders and layout information so you can get a head start on finishing this quilt, please watch this week's YouTube video at DKohn Designs.* The written pattern information will be published in Week #8 (next week). Sashing will be added to the blocks and rows in Week #8. Borders and finishing information will also be given in Week #8.

PATTERN NOTES: 1) You may want to make the roof and door from contrasting fabric with scraps left over from previous blocks rather than cutting into new 10 inch squares. 2) Fabric requirements below are for 10" squares and 40" – 42" WOF. 3) ¼ inch seam is always used. 4) RST means right sides together. 5) Follow pressing directions to reduce bulk in the block. 4) Press and trim to unit dimensions as directed after every addition to the block for most accurate results.

MATERIALS LIST:

PRINT A (Roof) – you may want to use contrasting scraps left over from previous blocks.

PRINT B, C (walls, wall top) – you will need to use 5 complete 10" squares.

PRINT D (door) – you may want to use contrasting scraps left from previous blocks.

BACKGROUND – 12 inches x WOF

CUTTING INSTRUCTIONS: 1) Cut fabrics as indicated in the chart below. SEE FABRIC CUTTING SUBSTITUTIONS BELOW DEPENDING ON USAGE OF LAYER CAKE/YARDAGE/SCRAPS. 2) Organize all the subcut pieces by alphabet label to facilitate piecing. **See labels on page 3 to print out if desired.**

CUTTING CHART (everything needed for all 5 blocks)

<u>SECTION</u>	<u>FABRIC</u>	<u># OF PIECES</u>	<u>FABRIC</u>	<u>LETTER</u>
Roof	PRINT (Use leftover scraps OR 5 – 10" squares)	5	5" x 5" squares	A
Walls	PRINT	10	3" x 5 ½" rectangles	B
Wall Top (above Door)	PRINT	5	2 ½" x 3" rectangles	C
Door	PRINT (can use scraps)	5	2 ½" x 3" rectangles	D
Roof Background	BACKGROUND	5	5" x 5" squares	E
Roof Sides	BACKGROUND	10	1" x 4 ½" rectangles	F
Walls Sides	BACKGROUND	10	1 ½" X 5 ½" rectangles	G

FABRIC CUTTING SUBSTITUTIONS:

IF USING 10 INCH "LAYER CAKE"- PRINT: choose (5) 10" squares. Make sure each square measures at least 10" x 10" before subcutting.

IF USING YARDAGE/ SCRAPS – PRINT: Cut Fabrics A - D rectangles from yardage or scraps in the sizes listed in the cutting chart and use in lieu of 10 inch precut squares.



BLOCK ASSEMBLY: Make (5) 9 1/2" X 9 1/2" blocks (unfinished). *NOTE: Illustrations are not to scale.*

For ONE HOUSE BLOCK:

Construct the ROOF Unit:

- 1) Make the Half Square Triangle (HST): A) Select 1 Print Fabric A square and 1 Background Fabric E square. Draw a solid diagonal line from corner to corner on the wrong side of the Fabric E square. B) Next, draw two dotted lines parallel to the diagonal line, one on each side 1/4" away from the diagonal line. The solid line is the cutting line, the dotted lines are the sewing lines. C) Place 1 Fabric A square and 1 Fabric E square RST and sew on both dotted diagonal lines. Cut apart on the solid diagonal line. Press seams toward the print triangles. Trim the resulting two HSTs to 4 1/2" square.

Half-Square Triangle Unit



Wrong side of E square

- 2) Sew the two HSTs RST with the backgrounds toward the outside (roof prints touching). Press seam open, trim to 8 1/2" x 4 1/2". This is the Roof section.

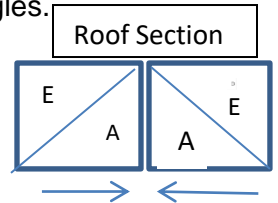

- 3) Select 2 Background Fabric F rectangles. Sew 1 Fabric F rectangle to the left side of the Roof, Sew 2nd Fabric F rectangle to the right side of the Roof. Press seams open. Trim to 9 1/2" x 4 1/2". This is the Roof Unit.

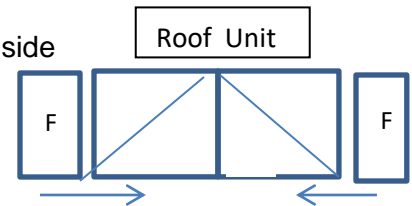

Construct the WALLS/DOOR Unit:

- 4) A) Mark the center of 1 Print Fabric C (Wall Top) rectangle vertically on the wrong side of the piece. You will use this mark to match the wall unit and roof unit at the centers when joining the units together. B) Sew 1 Print Fabric C (Wall Top) rectangle to the top of 1 Print Fabric D (Door) rectangle RST. Finger press the seam open. This is the Door section.

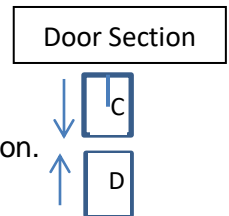

- 5) A) Sew 1 Print Fabric B (Walls) rectangle to the left side of the Wall Top/Door unit RST. B) Sew 2nd Print Fabric B rectangle to the right side of the Wall Top/Door unit RST. C) Press seams away from the center of the block. Trim to 7 1/2" x 5 1/2". This is the Walls/Door Section.

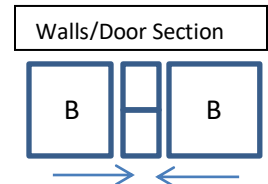

- 6) Select 2 Background Fabric G rectangles. Sew 1 Fabric G rectangle to the left side of the Walls/Door unit. Sew 2nd Fabric G rectangle to the right side of the Walls/Door section. Press the seams away from the center of the block. Trim to 9 1/2" x 5 1/2". This is the Walls/Door Unit.

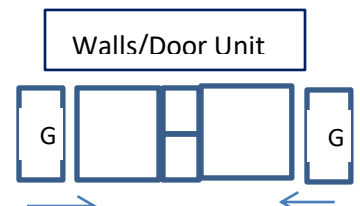

Assembling the House Block:

- 7) Using the center Roof Unit seam and the drawn mark from the Walls Unit in Step 4A above, center the Roof Unit on top of the Walls Unit by matching the seam and mark together. Pin and sew RST. B) Press the seam toward the Walls unit to reduce bulk at the roof points. Square the Block to 9 1/2" x 9 1/2".

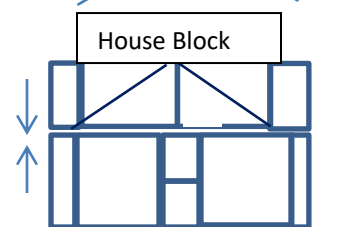

Make 4 additional Blocks for a total of 5 House Blocks = Row 6. Congratulations! If you already sewed the blocks for Rows 1 – 5, then you have completed all of the Blocks for this Quilt!

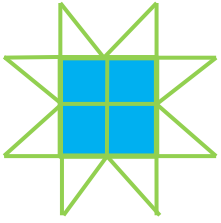

Fabric Piecing Labels for your personal use only:

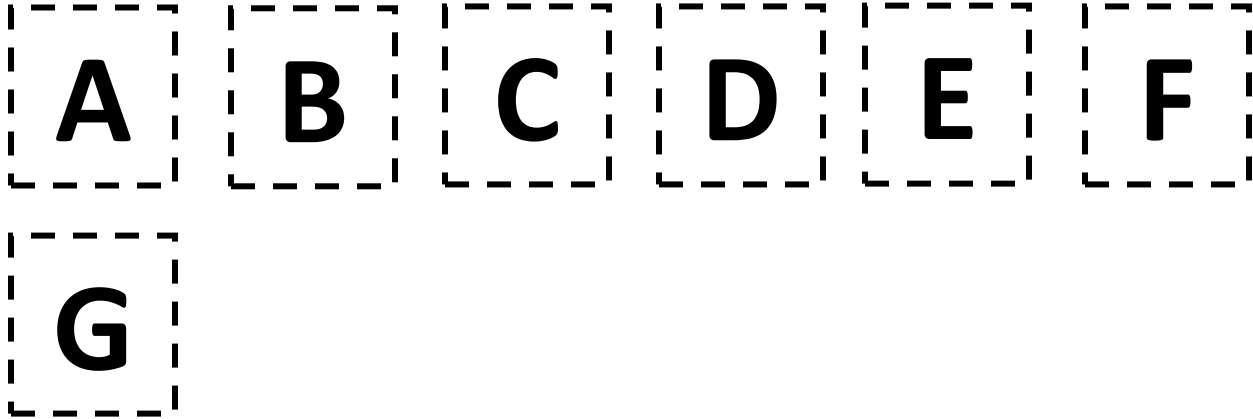

Copyright 2021 by DKohn Designs, all rights reserved. Do not copy, reprint, reproduce or post this pattern or parts of this pattern without express written permission from DKohn Designs.

Website and Blog: www.DKohnDesigns.com YouTube: DKohn Designs Contact: info@Dkohndesigns.com

P.S. You may want to check my website at DkohnDesigns.com under “pattern updates” in case there are any errata discovered after publication. I apologize if this happens.